

Project

Date Product Code

Type

Designer



# WAFER/2 AA

recessed shallow LED accent light

FULLY SUSTAINABLE – FULLY SUSTAINABLE – FULLY SUSTAINABLE – FULLY SUSTAINABLE – FULLY SUSTAINABLE – FULLY SUSTAINABLE – FULLY SUSTAINABLE



slot aperture shown

## FEATURES

- **WAFER/2 AA is a 2" aperture LED accent light** with an overall depth of 4" (housing depth of 3" plus a 1" throat).
- **Luminaire provides 365° rotation and 0°-30° angular adjustment.** Once focused, adjustment may be locked by a lever and a thumb nut.
- **Luminaire employs an internal spring-loaded lens** to produce an initial beam-spread of either 12°, 20° or 36°. To allow beamspread to be changed in installed luminaires, internal lenses are available as accessories.
- **Luminaire is powered by one of a number of Cree Chip on board LED's.** See below for wattages and efficacies.
- Luminaire is available with **four kinds of LightPlate trim**:
  - with a slot aperture and no lens (- AL)
  - with a slot aperture and prismatic lens (- AL-PRS)
  - with a round aperture and no lens (- AP)
  - with a round aperture and prismatic lens (- AP-PRS)
- **LightPlate trim with white finish** standard. Custom color finish available on special order.
- **Optional housing design for residential installation** in wood joist ceilings (- RI).
- **WAFER/2 AA includes a pair of mounting bars** (3/4" x 27" C channel). Specialty bars for wood and T-bar installations are also available.
- **For more information, [click here](#).**

## APPLICATIONS

Luminaire is listed as an inherently protected luminaire for Damp Location. Luminaire is RoHS compliant, is suitable for use in a fire rated ceiling. Removal of the external reflector allows access to the LED module and junction box.



round aperture shown

## PRODUCT CODE

For complete product code, list basic unit and select one item from each following box.

<b>Basic Unit</b> .....	standard installation design.....	W2-CLT-AA
<b>Internal Lens</b> <i>Choose one.</i>		
12° initial beamspread .....		- 12D
20° initial beamspread .....		- 20D
36° initial beamspread .....		- 36D
<b>Light Source Output (Lumens)</b>		
800 lumens / CRI 90+ .....	2700K & 3000K only.....	- L08H
1000 lumens .....	2700K & 3000K only.....	- L10H
1200 lumens .....	2700K & 3000K only.....	- L12H
1000 lumens / CRI 80+ .....		- L10S
1200 lumens.....		- L12S
1500 lumens.....		- L15S

<b>Driver</b>	
dimmable to 1% by a 0-10V dimmer on 120 Or 277-volt service.....	- DMV
dimmable to 5% by either an incandescent or electronic low voltage dimmer only; 120-volt service only.....	- DMP
dimmable to 1% by a 2-wire Lutron compatible dimmer .....	- DMILU
dimmable to 1% SoftOn/FadeToBlack by a Lutron EcoSystem control .....	- ECO-LU
eldoLED 0-10V (Logarithmic) driver dimmable to 0.1% with a 0-10V dimmer .....	- DV0ELG
eldoLED 0-10V (Linear) driver dimmable to 0.1% with a 0-10V dimmer .....	- DV0ELN
eldoLED driver dimmable to 0.1% with DALI control system .....	- DA0-EL
dimmable to 0.1% by a Zigbee wireless network (Daintree, Encelium or Wink); wireless range 50' through standard walls; available with L12H or L15S models only .....	- ZGOMAG

<b>Light Color</b>	
2700 K.....	- 27K
3000 K.....	- 30K
3500 K.....	- 35K
4000 K.....	- 40K

LightPlate	Overlap (OL)	Trim Flush (TF)*
slot aperture, no lens .....	AL-OL.....	AL-TF
slot aperture with prismatic lens.....	AL-PRS-OL.....	AL-PRS-TF
round aperture, no lens.....	AP-OL .....	AP-TF
round aperture with prismatic lens.....	AP-PRS-OL .....	AP-PRS-TF

Standard LightPlate white finish. Add – CC for custom color.  
\*Trim Flush LightPlate requires the use of a **plaster ring** Accessory (see below).

## OPTIONS

Specify by adding to the basic unit.

<b>Housing designed for residential installation</b> (see next page) including a pair of mounting bars (extendable to 20") for use between wood joists. ....	- RI
<b>Millwork trim detail</b> consists of an aperture collar (see below) and a Trim Flush (TF) external reflector (see above).	
milled aluminum aperture collar .....	- M
white aperture collar .....	- MWH
black aperture collar .....	- MBL
custom color aperture collar.....	- MCC
<b>Remote emergency battery pack</b> including two components – battery pack and plate with test switch and light – to be mounted adjacent to luminaire; for use in accessible ceilings; not available with residential housing (-RI). ..	- RX

## EXTRA INTERNAL LENSES

Specify as separate line items.

<b>12° internal lens</b> .....	CLT-LENS12-50
<b>20° internal lens</b> .....	CLT-LENS20-50
<b>36° internal lens</b> .....	CLT-LENS36-50

## ACCESSORIES

Specify as a separate line item.

<b>Plaster ring</b> allows use of 3 3/4" OD Trim Flush (-TF) reflector in sheetrock ceiling; 4" dia hole required.....	TF RING/3
--	-----------



## STANDARD INSTALLATION DESIGN

Requires ceiling opening of 3 3/4" (95mm) for Overlap Detail.  
 Requires ceiling opening of 4" (102mm) for Trim Flush Detail.  
 Requires minimum ceiling opening of 3.90" (99mm) for Millwork Trim Detail.

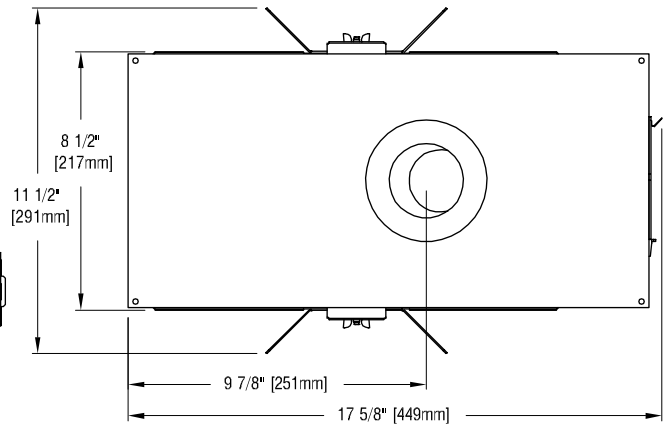
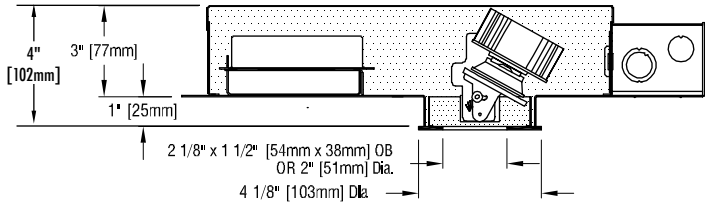

## RESIDENTIAL INSTALLATION DESIGN (-RI)

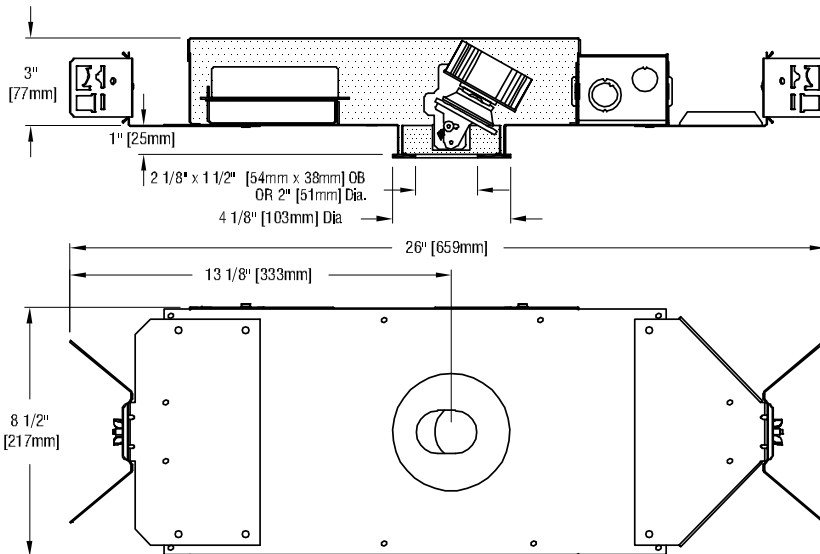

### EXTERNAL REFLECTOR TRIM DETAILS

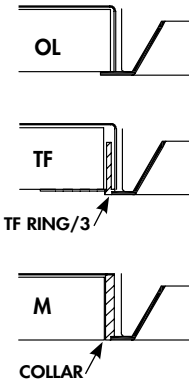

### STANDARD DMV DRIVER INFORMATION (UL Class 2, dry and damp location)

Voltage	120	277
Input Watts (L108H/L110H/L12H/L10S/L12S/L15S)	9/10/13/9/10/13	9/10/13/9/10/13
Input Current (A) (L108H/L110H/L12H/L10S/L12S/L15S)	08/08/11/08/08/11	04/04/06/04/04/06
Output Current (mA)	350-700	350-700
Min. Power Factor	.99	.99
Operating Temperature Range (F)	-13 to 122	-13 to 122

### LIGHT OUTPUT MULTIPLIER

LED Light Engine	Light Output Multiplier	RX Light Output Multiplier
800 Lumens 90 CRI	0.84*	.55
1000 Lumens 90 CRI	1	.55
1200 Lumens 90 CRI	1.23*	.55
1000 Lumens 80 CRI	1.04*	.67
1200 Lumens 80 CRI	1.24*	.67
1500 Lumens 80 CRI	1.53*	.67

\*estimated values

### REFLECTOR COLOR MULTIPLIERS

Slightly diffuse clear (V)	1
Fully diffuse clear (EC)	.90
Champagne gold clear (G)	1
Specular white (W)	.70
Black (B)	.40

– photometrics continued below –



## PHOTOMETRIC REPORT with 12° lens (tested per IESNA LM-79-2008)

Verification Services Report No. 11863545.01. Original test report furnished upon request.

Luminaire ..... recessed LED round accent light with slot aperture plate trim and prismatic lens, LED aimed at 15° above vertical.+  
 Light Source ..... Cree CXB1310 LED with 12° beam spread integral lens, 2700K CCT, 90 CRI, 1000 lumens

### CANDLEPOWER DISTRIBUTION (Candela)

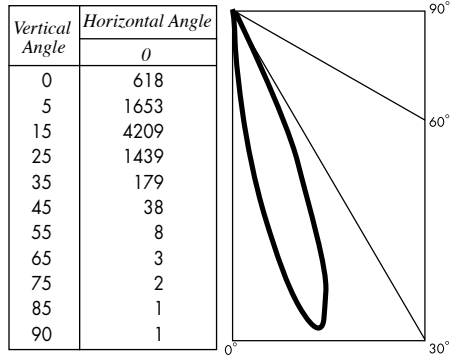

### LUMINAIRE LIGHT OUTPUT AND EFFICACY

LED Light Engine	Luminaire Light Output	Luminaire CBCP	Luminaire Efficacy (lms/watt)	System Wattage	RX Light Output (90 min. run)
800 Lumens 90 CRI	404*	3536*	45*	9	264*
1000 Lumens 90 CRI	481	4209	47	10	264*
1200 Lumens 90 CRI	591*	5177*	45*	13	264*
1000 Lumens 80 CRI	500*	4377*	56*	9	322*
1200 Lumens 80 CRI	596*	5219*	60*	10	322*
1500 Lumens 80 CRI	735*	6440*	57*	13	322*

\*estimated values

## PHOTOMETRIC REPORT with 20° lens (tested per IESNA LM-79-2008)

Verification Services Report No. 11863545.02. Original test report furnished upon request.

Luminaire ..... recessed LED round accent light with slot aperture plate trim and prismatic lens, LED aimed at 15° above vertical.+  
 Light Source ..... Cree CXB1310 LED with 20° beam spread integral lens, 2700K CCT, 90 CRI, 1000 lumens

### CANDLEPOWER DISTRIBUTION (Candela)

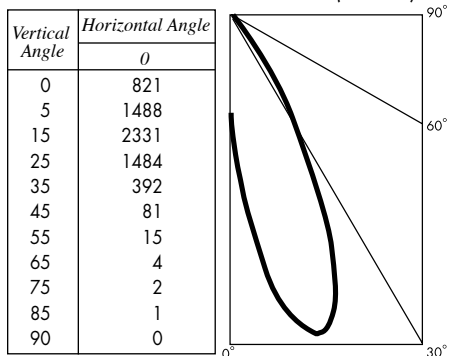

### LUMINAIRE LIGHT OUTPUT AND EFFICACY

LED Light Engine	Luminaire Light Output	Luminaire CBCP	Luminaire Efficacy (lms/watt)	System Wattage	RX Light Output (90 min. run)
800 Lumens 90 CRI	430*	1958*	48*	9	281*
1000 Lumens 90 CRI	512	2331	50	10	281*
1200 Lumens 90 CRI	629*	2867*	48*	13	281*
1000 Lumens 80 CRI	532*	2424*	59*	9	343*
1200 Lumens 80 CRI	634*	2890*	63*	10	343*
1500 Lumens 80 CRI	783*	3566*	60*	13	343*

\*estimated values

## PHOTOMETRIC REPORT with 36° lens (tested per IESNA LM-79-2008)

Verification Services Report No. 11863545.03. Original test report furnished upon request.

Luminaire ..... recessed LED round accent light with slot aperture plate trim and prismatic lens, LED aimed at 15° above vertical.+  
 Light Source ..... Cree CXB1310 LED with 36° beam spread integral lens, 2700K CCT, 90 CRI, 1000 lumens

### CANDLEPOWER DISTRIBUTION (Candela)

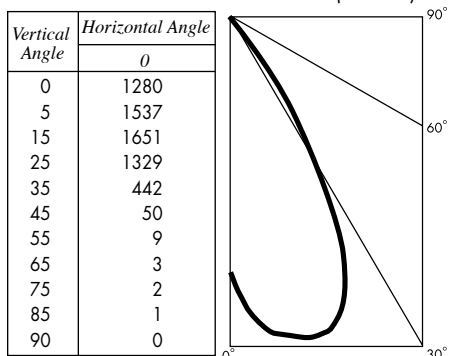

### LUMINAIRE LIGHT OUTPUT AND EFFICACY

LED Light Engine	Luminaire Light Output	Luminaire CBCP	Luminaire Efficacy (lms/watt)	System Wattage	RX Light Output (90 min. run)
800 Lumens 90 CRI	476*	1387*	53*	9	312*
1000 Lumens 90 CRI	567	1651	55	10	312*
1200 Lumens 90 CRI	697*	2031*	54*	13	312*
1000 Lumens 80 CRI	590*	1717*	66*	9	380*
1200 Lumens 80 CRI	703*	2047*	70*	10	380*
1500 Lumens 80 CRI	867*	2526*	67*	13	380*

\*estimated values