

Project

Type



Date Product Code

Designer

SPREDLITE® HI DL/12

cove mounted baffled LED wall grazing luminaire

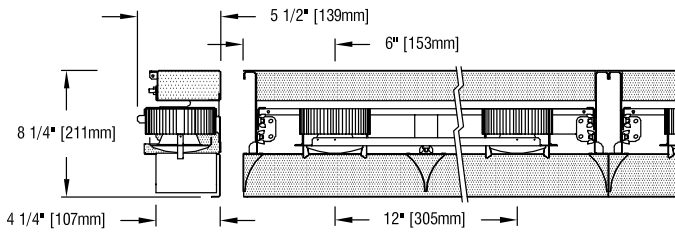

- **Spredlite HI DL/12 is a luminaire designed to provide uniform grazing illumination** on vertical surfaces as high as 35' using integral LED modules and spread lenses, as well as interposed baffles, mounted at 12" (305 mm) centers.
- **Luminaire is powered by Cree chip-on-board LED** modules of one of a range of light outputs. See tables below for luminaire wattages and efficacies.
- Luminaire operates on either 120-volt or 277-volt service.
- **Luminaire is designed for surface mounting** in a ventilated architectural light cove (see next page for dimension detail). Modular segments are installed end-to-end as needed to form a continuous run. Each segment provides lockable 0° to 10° angular adjustment allowing precise illumination of the vertical surface below.
- **Parabolic baffles** located between the LED modules provide a 25° shielding angle down the length of the Spredlite and minimize lamp brightness. Baffles are available in clear, champagne gold or black Alzak®.



Standard finishes are a matte black housing and a matte white back panel. Housing available on special order in custom color paint finish. Reflective back panel must remain white. For more information, [click here](#).

APPLICATIONS

Fixture provides excellent illumination of specular wall surfaces with no distracting reflections.

Fixture is listed for Cove Mounting and Damp Location. Fixture is approved for 90°C supply wiring. Electrical supply is provided from adjacent accessible outlet boxes (supplied by others).

INSTALLATION

Dimensions: the segment lengths listed under "Product Code" are precise; segments can be bolted end-to-end to ensure uniform lamp spacing.

Mounting: secure segments to wood or metal framing members only.

Ends and Corners: leave at least 1" between the end of a cove and the nearest segment, and at least 2" between segments at corners.

Ventilation: the cove must be vented to ensure proper Spredlite performance and maximize driver life. See details below.

Warranty Detail

Our 5-year warranty does not include the provision of scaffolding, man-lifts, 'cherry pickers' or other extraordinary means of access to a product requiring maintenance.

In the boxes below, record the number of segments you will need for your Spredlite order. The worksheet on page 3 will help you decide.

PRODUCT CODE

The product code for a Spredlite segment includes the Basic Unit and a Segment Length. The product code for a Spredlite run includes a list of the segments required; see example below.

Basic Unit SPR-CLPH2-DL12

Driver

DMV: drivers dimmable to 1% by a 0-10V dimmer - DMV
 DVOELG: eldoLED 0-10V (Logarithmic) drivers dimmable to 0.1% with a 0-10V dimmer - DVOELG
 DVOELN: eldoLED 0-10V (Linear) drivers dimmable to 0.1% with a 0-10V dimmer - DVOELN
 DAO-EL: eldoLED drivers dimmable to 0.1%, compatible with DALI control system - DAO-EL

Light Source Output

2300 lumens / CRI 92 2700K & 3000K only - L23H
 2600 lumens / CRI 80+ - L26S

Light Color

2700K - 27K
 3000K - 30K
 3500K not available with CRI 92 modules - 35K
 4000K not available with CRI 92 modules - 40K
 5000K not available with CRI 92 modules - 50K

Segment Length

two-module segment, 24" long -24



three-module segment, 36" long -36



four-module segment, 48" long -48



Custom painted segment housings are available on special order. Add -CCH

Baffle color

clear (natural aluminum) -C
 gold -G
 black -B



See table below for cove dimension and ventilation requirements.

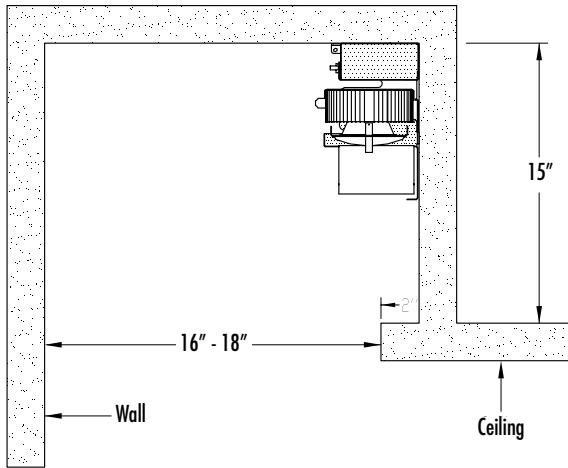

COVE DIMENSION AND VENTILATION REQUIREMENTS

| Ceiling Height | Cove Opening | Cove Height | Recommended Light Source Output |
|----------------|--------------|-------------|---------------------------------|
| 30' | 16" | 15" | all lumen levels |
| 35' | 18" | 15" | all lumen levels |

Ventilation: Provide 3 square inches of void per linear foot of cove. To avoid overheating the LED modules and/or drivers, air temperature inside cove should not exceed 122F.

Leading Testing Laboratories Report No. UT18070002-03a (prorated). Original test report furnished upon request.

WALLWASH INFORMATION (Vertical Footcandles)

| Distance Below Finished Ceiling (ft) | 35' High Ceiling | 30' High Ceiling |
|--------------------------------------|---------------------|---------------------|
| | 2600 lumens per LED | 2300 lumens per LED |
| 1 | 108 | 106 |
| 2 | 104 | 103 |
| 3 | 109 | 98 |
| 4 | 94 | 81 |
| 5 | 81 | 70 |
| 6 | 73 | 63 |
| 7 | 66 | 56 |
| 8 | 60 | 50 |
| 9 | 54 | 45 |
| 10 | 49 | 40 |
| 11 | 44 | 35 |
| 12 | 40 | 32 |
| 13 | 36 | 29 |
| 14 | 32 | 26 |
| 15 | 29 | 23 |
| 16 | 26 | 21 |
| 17 | 23 | 19 |
| 18 | 21 | 17 |
| 19 | 19 | 15 |
| 20 | 17 | 14 |
| 21 | 16 | 12 |
| 22 | 14 | 11 |
| 23 | 13 | 10 |
| 24 | 12 | 9 |
| 25 | 11 | 9 |
| 26 | 10 | 8 |
| 27 | 9 | 8 |
| 28 | 9 | 7 |
| 29 | 8 | 7 |
| 30 | 7 | 5 |
| 31 | 7 | |
| 32 | 7 | |
| 33 | 7 | |
| 34 | 7 | |
| 35 | 4 | |

All vertical footcandles are initial values at the center of a 15' continuous length of Spredlite HI DL/12 with specific light output option shown in the table. Architectural light coves were modeled for each ceiling height using dimensions suggested below. Calculations assume 80% reflectance for the architectural light cove surface, 50% and 20% reflectance for lighted wall and floor.

LUMINAIRE LIGHT OUTPUT AND EFFICACY (one LED module)

| LED Module Type | Luminaire Light Output | Luminaire Efficacy (lms/watt) | System Wattage |
|----------------------------|------------------------|-------------------------------|----------------|
| 2300 Lumens 90+ CRI (L23H) | 1558* | 63* | 25 |
| 2600 Lumens 80+ CRI (L26S) | 1791 | 72 | 25 |

*estimated values

DRIVER INFORMATION (one LED module)

UL Class 2, dry and damp location

| Voltage | 120 | 277 |
|----------------------------------|-----------|-----------|
| Input Watts (L23H/L26S Lumens) | 25/25 | 25/25 |
| Input Current (L23H/L26S Lumens) | .21/.21 | .09/.09 |
| Output Current (mA) | 600 | 600 |
| Min. Power Factor | >0.95 | >0.95 |
| Operating Temperature Range (F) | -4 to 113 | -4 to 113 |

COLOR TEMPERATURE MULTIPLIER (use 3000K as the base)

| Color Temperature | Multiplier |
|-------------------|------------|
| 2700K | 0.96* |
| 3000K | 1 |
| 3500K | 1.03* |
| 4000K | 1.06* |
| 5000K | 1.07* |

*estimated values

LIGHT OUTPUT MULTIPLIERS (use L21S as base)

| LED Module Type | Light Output Multiplier |
|----------------------------|-------------------------|
| 2300 Lumens 90+ CRI (L23H) | 0.87* |
| 2600 Lumens 80+ CRI (L26S) | 1 |

*estimated values

This sheet will help you pick which segments in which quantities will add up to a Spredlite run for the architectural cove or trough on your project.

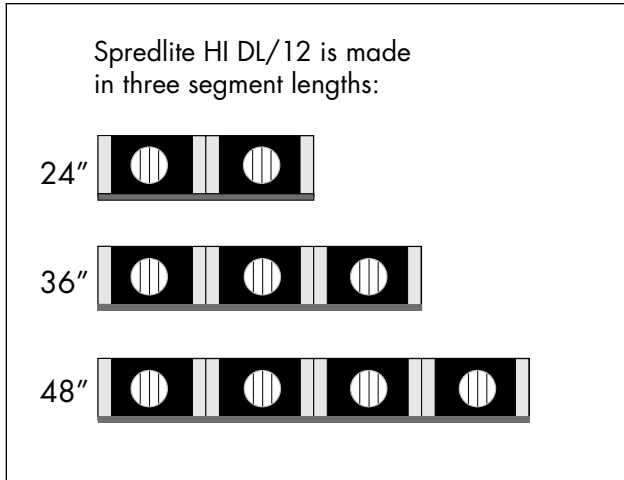

SUGGESTED RUN LAYOUTS

| Length of Run | Spredlite Segments | | |
|---------------|--------------------|-----|-----|
| | 24" | 36" | 48" |
| 2' 0" | 1 | | |
| 3' 0" | | 1 | |
| 4' 0" | | | 1 |
| 5' 0" | 1 | 1 | |
| 6' 0" | | 2 | |
| 7' 0" | | 1 | 1 |
| 8' 0" | | | 2 |
| 9' 0" | | 3 | |
| 10' 0" | 1 | | 2 |
| 11' 0" | | 1 | 2 |
| 12' 0" | | | 3 |
| 13' 0" | | 3 | 1 |
| 14' 0" | | 2 | 2 |
| 15' 0" | | 1 | 3 |
| 16' 0" | | | 4 |
| 17' 0" | 1 | 1 | 3 |
| 18' 0" | | 2 | 3 |
| 19' 0" | | 1 | 4 |
| 20' 0" | | | 5 |
| 21' 0" | 1 | 1 | 4 |
| 22' 0" | | 2 | 4 |
| 23' 0" | | 1 | 5 |
| 24' 0" | | | 6 |
| 25' 0" | 1 | 1 | 5 |
| 26' 0" | | 2 | 5 |
| 27' 0" | | 1 | 6 |
| 28' 0" | | | 7 |
| 29' 0" | 1 | 1 | 6 |
| 30' 0" | | 2 | 6 |
| 31' 0" | | 1 | 7 |
| 32' 0" | | | 8 |

INSTALLATION GUIDELINES

Remember:

- the segment lengths listed are precise "out-to-out" dimensions
- segments can be bolted together to ensure uniform lamp spacing
- leave at least 1" between the end of the cove and the end of the nearest segment
- leave at least 2" between segments at corners