

# INSTALLATION INSTRUCTIONS

## IMPORTANT

*These fixtures take Trim Flush (-TF) reflectors and are intended for use in a sheetrock ceiling. Install the fixture housing only as shown on the enclosed (white) Installation Instructions. Coordinate with the ceiling contractor to ensure that ceiling is finished as shown below.*

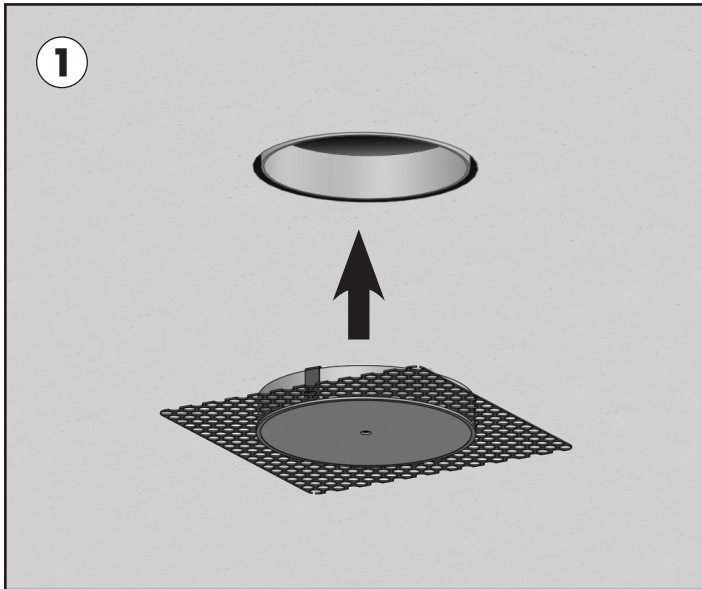

Ceiling contractor: insert TF Ring Accessory into aperture of fixture housing.

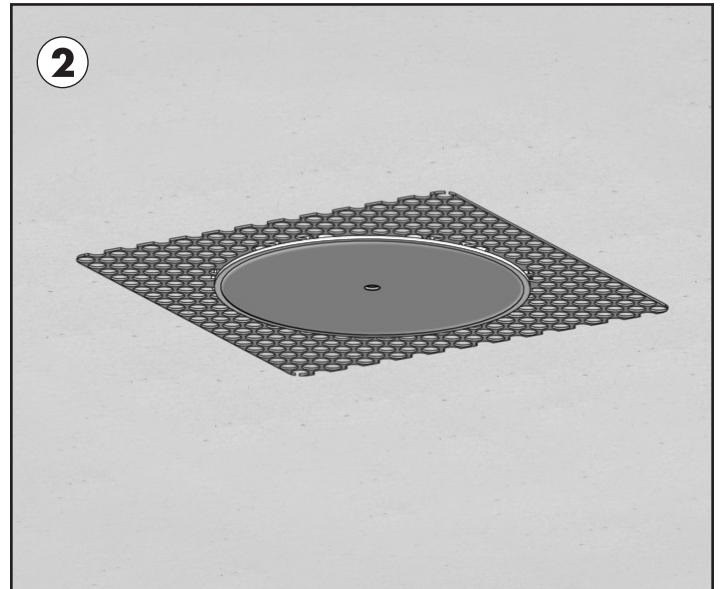

When TF Ring Accessory is fully inserted, the spackle screen should be touching the sheetrock at all points.

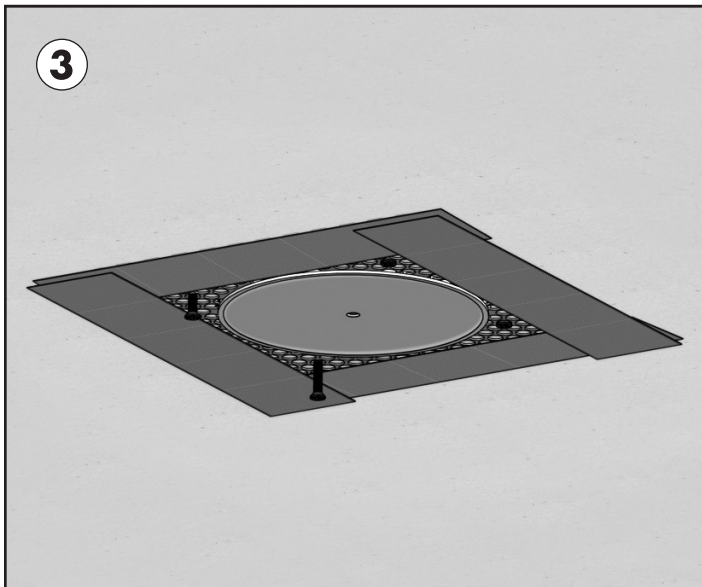

Secure spackle screen to sheetrock with  $\frac{3}{4}$ " sheetrock screws and with self-adhesive fiberglass drywall joint tape at edges.

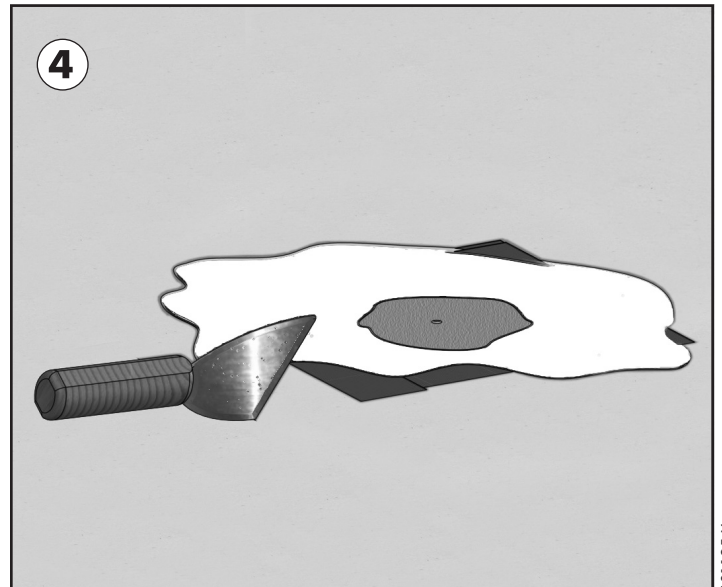

Apply two coats of drywall compound, sanding between coats. Be careful to leave the center of the protective disc free of compound.

601195-X

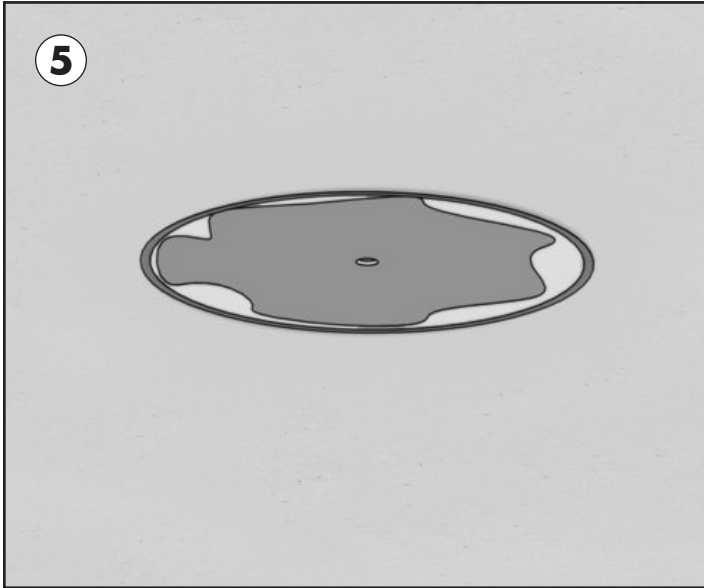

Final sanding should leave the rim of the TF Ring exposed.

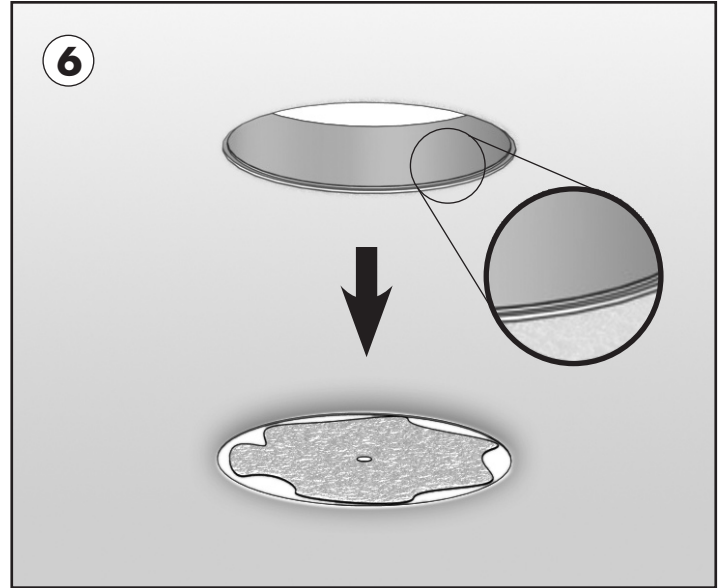

Remove the protective disc, make sure that the interior rim of the TF Ring is free of compound, and insert the second, clean protective disc. (Two discs are shipped with each Ring.)

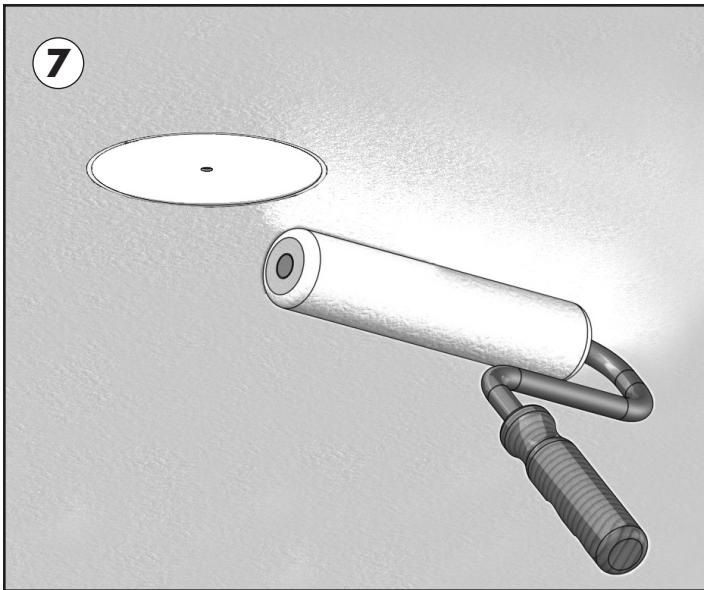

Prime and paint.

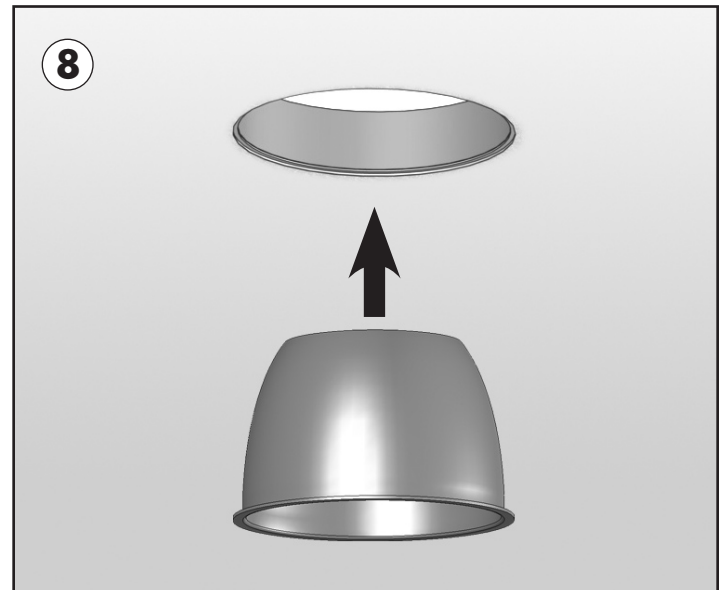

Electrician can now remove protective disc and insert reflector into fixture aperture, as shown in the fixture's Installation Instructions.